

N-29- Copy - deed from John Brown to Hans Madson and Caleb Parry, July, 10-1876 - Pt. N.W. 1/4 Sec. 70. T. 6. N. R. 1. W. - Beg. 24.97 chs. South and 20.75 chs East from the N.W. cor. of said 1/4 Sec (and in middle of street) running thence North 1.21 chs, and on E. bank of water sect, N. 64 1/4° W. 4.37 chs, - N. 51 1/4° W. 8.20 chs - N. 57° 0' W. 8.70 chs, on N. bank of water sect, thence N 49° E. 9.66 chs, to channel of Mill Creek, S. 47 1/2° E. 2.55 chs, up said channel of creek to dam in creek N. 0.75 chs in water sect, thence S. 34° W. 2.62 chs to middle of street - thence West 6.35 chs to beg. 19.76 a, more or less being bounded on the East by Mill Creek, and on the West by the North bank of the water sect. All water rights pertaining to the above sect, excepting for the purpose of irrigating said land are hereby reserved - also the right of enlarging or repairing said sect, at the pleasure of the grantor.

center: 24th Street.

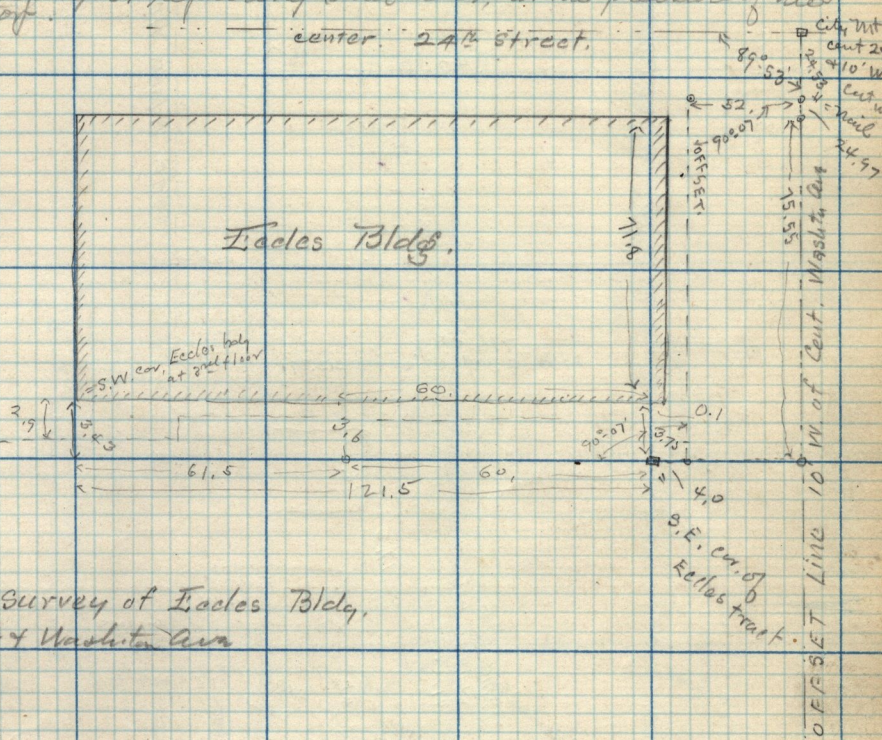

No. 28-03 Survey of Eccles Bldg.
on Cor. 24th & Wash. Ave

